

Serial #3040410 and below

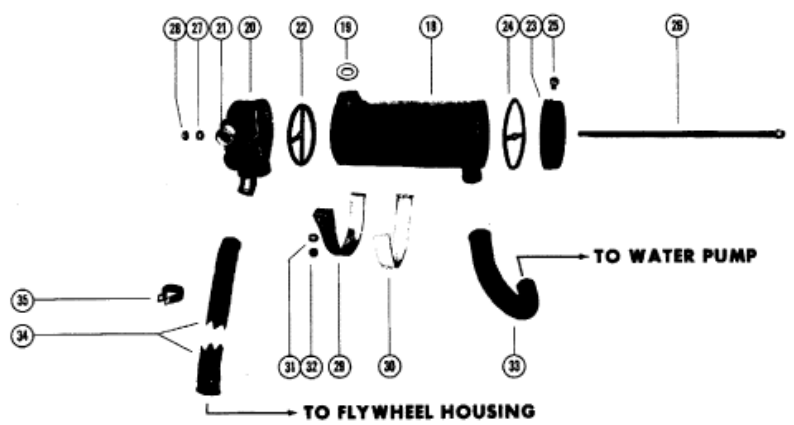

Parts List						
Ref	Class	Part	Description	Qty	Comment	Footnote
-		55125A 4	FRESH WATER COOLING KIT (SE	1		
1		55125A 7	RESERVOIR ASSEMBLY	1		
-	37	53237	DECAL, RESERVOIR	1		
2	32	55126	TUBE, OVERFLOW	1		
3	16	29988	STUD, HEAT EXCHANGER S1	2		
4	16	21553	STUD, THERMOSTAT COVEF	1		
5	22	58471	SLEEVE, WATER FILLER	1		
6	36	55143	CAP, RESERVOIR WATER FILL	1		
7		55128	END CAP, EXHAUST MANIFOLD	2		
8	32	57929 3	HOSE, CONNECTOR - END CAP	2		
9	54	38889	CLAMP, CONNECTOR HOSE TC	4		
10		58652	PLATE, END CAP TO EXHAUST	2		
11	27	48043	GASKET, END CAP TO EXHAUS	6		
12	10	53016	SCREW, END CAP TO EXHAUS	6		
12	10	20362	SCREW, END CAP TO EXHAUS	2		
13	13	39107	LOCKWASHER, END CAP SCRE	8		
14	12	26825	WASHER, END CAP SCREW	8		
15		57925	BRACE, RESERVOIR TO INTAK	1		
15		57926	BRACE, RE SERVOIR TO INTAK	1		
16	12	20722	WASHER, BRACE TO RESERV	1		
17	10	57841	SCREW, BRACE TO INTAKE M	1		
17	10	20359	SCREW, BRACE TO INTAKE M	1		
18		55075A 1	HEAT EXCHANGER ASSEMBLY	1		
19	27	55144	GASKET, HEAT EXCHANGER IP	1		
20		55208A 1	END CAP ASSEMBLY, HEAT EX	1		
21	23	47511	SLEEVE, END CAP	2		
22	27	55136	GASKET, END CAP TO HEAT E	1		
23		55129	END CAP, HEAT EXCHANGER	1		
24	27	55138	GASKET, END CAP TO HEAT E	1		
25	22	32802	PLUG, PIPE - END CAP	1		
26	10	55137	SCREW, END CAP TO HEAT EX	1		
27	12	20553	WASHER, END CAP SCREW	2		
28	11	23161	NUT, END CAP SCREW	1		
29		55145	STRAP, MOUNTING - HEAT EXI	2		
30		55124	PADDING, MOUNTING STRAP	2		
31	12	20084	WASHER, MOUNTING STRAP	2		
32	11	25594	NUT, MOUNTING STRAP STUC	2		
33	32	57778	HOSE, HEAT EXCHANGER TO	1		
34	32	60125	HOSE, HEAT EXCH. TO POWE	1		
34A	32	57774	HOSE, HEAT EXCH. TO FLYWH	1		